



MARK TUNSTALL  
PROPERTY

# CHESTER ROW

LONDON SW1W





Chester Row is conveniently located in walking distance to the excellent public transport links (buses and Circle and District Underground lines) of Sloane Square and is moments from the superb array of shops, bars and eateries of the Kings's Road, Sloane Street and Elizabeth Street.

Unfurnished  
Viewing strictly by appointment with Mark Tunstall Property

APPROX. GROSS INTERNAL AREA \*  
1057 Sq Ft - 98.20 Sq M



Key :  
CH - Ceiling Height

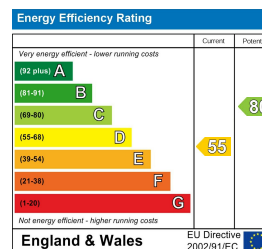
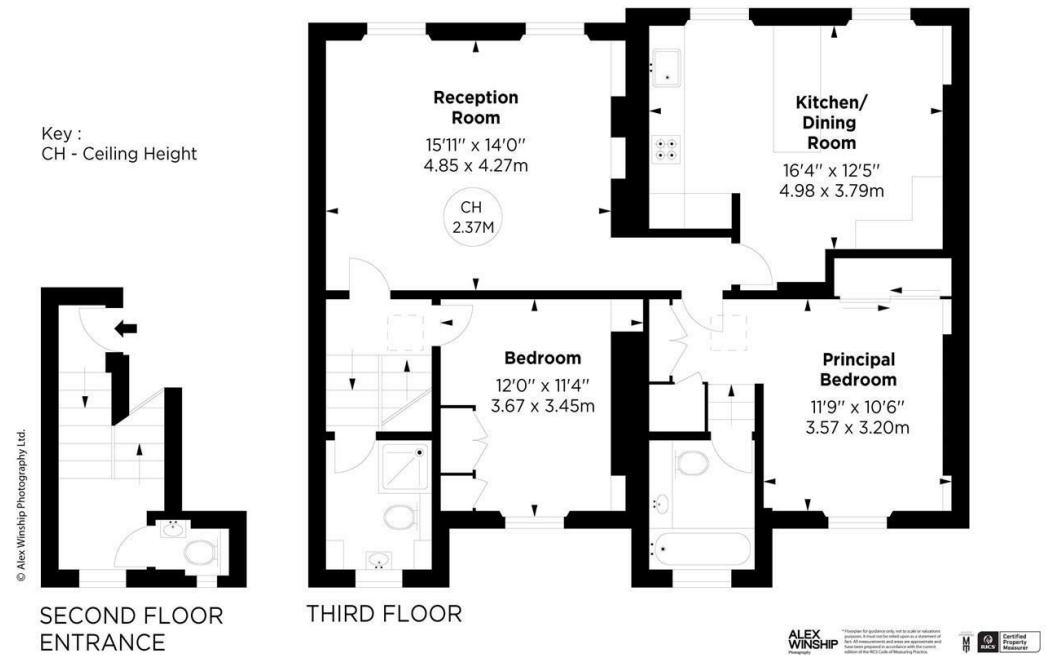

INFO@TUNSTALLPROPERTY.CO.UK  
+44 (0)20 3011 1775

THIS BROCHURE AND THE DESCRIPTIONS AND MEASUREMENTS HEREIN DO NOT CONSTITUTE REPRESENTATION AND WHILST EVERY EFFORT HAS BEEN MADE TO ENSURE ACCURACY, THIS CANNOT BE GUARANTEED. A COPY OF THE FULL ENERGY PERFORMANCE CERTIFICATE IS AVAILABLE UPON REQUEST.